

# Soundproof Window Treatments Sliding FRENCH DOORS Measuring Form

Name: \_\_\_\_\_

Address \_\_\_\_\_

\_\_\_\_\_

\_\_\_\_\_

Phone (day): \_\_\_\_\_ (evening): \_\_\_\_\_

Email: \_\_\_\_\_

FAX and VOICE contact: Toll-free 866-547-5376

www.EZsoundproof.com

GetQuiet@comcast.net

Door # \_\_\_\_\_

Door location: \_\_\_\_\_

**Measurements:**

Width | 1 - \_\_\_\_\_ Height | 3 - \_\_\_\_\_  
 | 2 - \_\_\_\_\_ | 4 - \_\_\_\_\_

Space between doorknob rosette and window frame | 5 - \_\_\_\_\_

**The Color You Want:**

White  Dark brown  Other \_\_\_\_\_

Door # \_\_\_\_\_

Door location: \_\_\_\_\_

**Measurements:**

Width | 1 - \_\_\_\_\_ Height | 3 - \_\_\_\_\_  
 | 2 - \_\_\_\_\_ | 4 - \_\_\_\_\_

Space between doorknob rosette and window frame | 5 - \_\_\_\_\_

**The Color You Want:**

White  Dark brown  Other \_\_\_\_\_

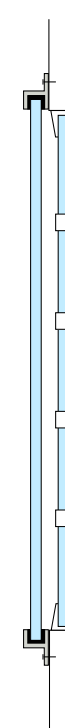
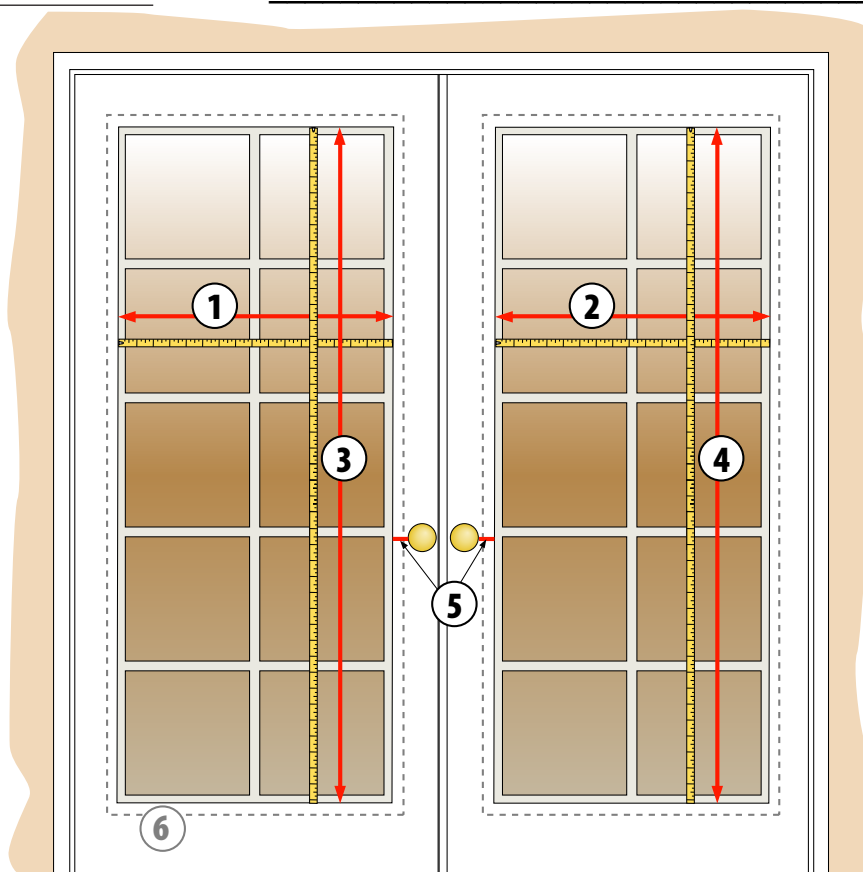

- ① and ② Measure full width of each window section. End to end, side to side.
- ③ and ④ Measure full height of each window section. End to end, top to bottom.
- ⑤ Measure distance between doorknob rosette and wood trim of existing windows.
- ⑥ Dotted line indicates 1.25-inch frame for Insulated Door Treatment.

Sound Proof French Door cross-section side view.